



jaga



Eyecatchers

IGUANA APLANO

€ 2016-2017.EX



Eyecatchers
* From design to art *

IGUANA APLANO

A child's drawing of the sun shining.

Warmth with a symbolic value. Inspired by a child's drawing, an interpretation of the brightly shining sun, transformed into a fully functional work of art.

With the Iguana Aplano the slim triangular radiant pipes are placed alongside each other in a flat plane. Elegant simplicity with a frivolous touch. Also available as "Plus" version for low flow temperatures.



Top 10
Design
Award
Winner
2000

ISM 1999
DESIGN PLUS
Special Honorary Award

IGUANA APLANO
traffic white 333, optional towel rail





IGUANA APLANO

IGUANA APLANO

DIMENSIONS (in cm)

APLANO APLANO PLUS

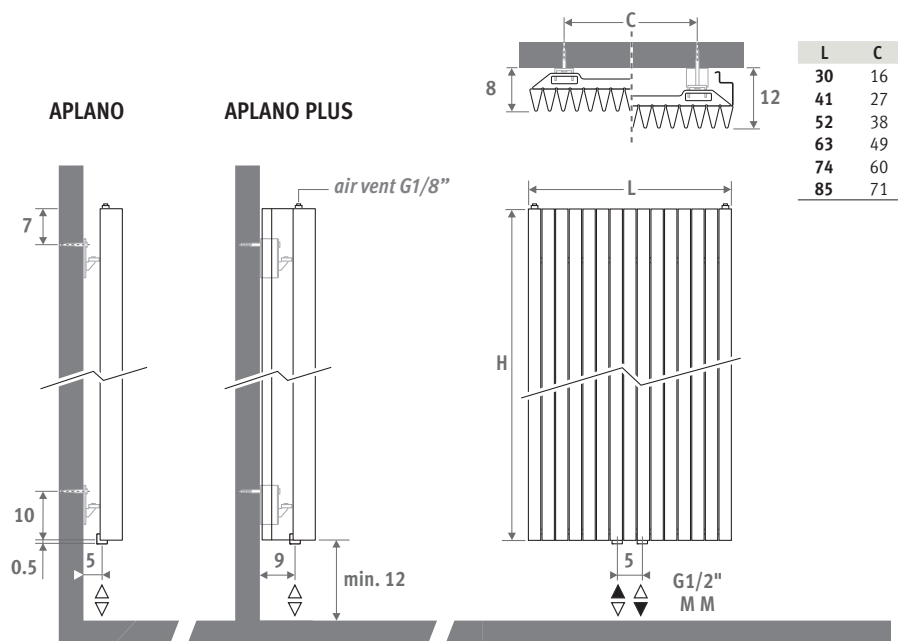

DELIVERY

- central connection MM underneath
- wall fixing
- 2 chrome-plated air vents G1/8"
- Iguana Plus is supplied with two side panels

COLOURS

Environmentally friendly, scratch-resistant, high UV resistant powder coating.

Standard colours:

- traffic white RAL 9016 (333), smooth satin matt
- sandblast grey (001), fine texture metallic

Other colours: see colour chart.

CONNECTION

Top connection: specify code 45 or 54 instead of MM (1° number is flow).

No insert pipe should be ordered. Provide an air vent on the central heating pipework.

One pipe connection: connection sets 41, 42, 48 or 49. Max. 2 radiators per heating ring.

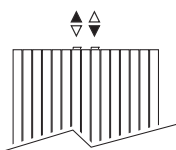

CONNECTION SETS

To guarantee the output of the Iguana models and to limit the pressure drop, Jaga recommends the use of 15/1 minimum diameter pipes.

Connection set to the wall with a Deco-Pro valve

TRV head and sleeve couplings included.



set 48

BRUSHED STAINLESS STEEL

CODE.PW3.PS.1... 215,80 €

set 41

CHROME

CODE.PW3.DW.1... 147,90 €

CODE.PW3.DC.1... 158,70 €

fill in sleeve coupling code

Precision metal tube 15/1 115

Precision metal tube 16/1 116

Precision metal tube 18/1 118

RPE/ALU tube 16/2 316

RPE/ALU tube 18/2 318

Other connections:

See chapter "Connection sets and valves" for all connection options and technical information

OPTIONS

Towel rail / hat rack in chrome-plated aluminium

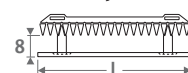

Hat rack consists of a towel rail and 5 coat hooks

CODE	L	L radiator	€
Towel rail			
9087.033560	56	41-52-63-74-85	202,30
9087.033660	66	63-74-85	202,30
Hat rack			
9087.034560	56	41-52-63-74-85	233,10
9087.034660	66	63-74-85	233,10



OPTION hat rack

IGUANA APLANO



APLANO

code	height	length	colour	conn.
APLW .	180	030 .	XXX	/MM
fill in colour code _____				

	Watts 75/65	Watts 55/45	€ st. colour	€ other
--	----------------	----------------	-----------------	------------

L	H 180			
030	700	352	448,60	538,30
041	954	480	585,50	702,60
052	1208	608	723,80	868,60
063	1463	736	861,10	1033,30
074	1717	864	997,80	1197,30
085	1972	992	1135,10	1362,10

L	H 192			
030	733	369	465,90	559,10
041	999	503	609,20	731,10
052	1265	637	751,60	901,80
063	1532	772	894,70	1073,60
074	1798	906	1038,60	1246,20
085	2065	1040	1181,70	1418,00

L	H 200			
030	754	380	476,50	571,70
041	1028	519	623,70	748,30
052	1302	657	771,30	925,60
063	1576	795	917,40	1100,80
074	1850	934	1065,20	1278,30
085	2124	1072	1212,40	1454,90

L	H 220			
030	804	407	503,60	604,40
041	1097	555	660,70	792,80
052	1389	703	818,00	981,50
063	1681	850	976,20	1171,40
074	1974	999	1133,20	1359,90
085	2266	1146	1290,20	1548,30

L	H 240			
030	851	432	530,90	637,00
041	1161	589	698,60	838,20
052	1471	746	865,50	1038,60
063	1780	903	1033,10	1239,60
074	2090	1061	1200,50	1440,60
085	2399	1217	1367,60	1641,20

APLANO PLUS

code	height	length	colour	conn.
APPW .	180	030 .	XXX	/MM
fill in colour code _____				

	Watts 75/65	Watts 55/45	€ st. colour	€ other
--	----------------	----------------	-----------------	------------

L	H 180			
030	964	465	583,30	699,80
041	1314	634	761,00	913,30
052	1664	802	940,80	1129,00
063	2015	972	1119,30	1343,10
074	2365	1140	1297,10	1556,50
085	2716	1310	1475,60	1770,70

L	H 192			
030	997	480	605,70	726,90
041	1359	655	792,00	950,50
052	1721	829	976,90	1172,30
063	2084	1004	1163,20	1395,80
074	2446	1179	1350,00	1620,00
085	2809	1354	1536,30	1843,50

L	H 200			
030	1018	491	619,40	743,30
041	1388	669	810,80	972,90
052	1758	847	1002,80	1203,30
063	2128	1026	1192,70	1431,30
074	2498	1204	1384,70	1661,70
085	2868	1382	1576,20	1891,40

L	H 220			
030	1070	515	654,70	785,60
041	1460	703	858,90	1030,60
052	1849	891	1063,20	1276,00
063	2238	1078	1268,80	1522,70
074	2627	1265	1473,20	1767,80
085	3016	1453	1677,50	2013,00

L	H 240			
030	1121	539	690,10	828,10
041	1529	736	908,00	1089,60
052	1936	932	1125,00	1350,00
063	2344	1128	1343,00	1611,50
074	2751	1324	1560,60	1872,70
085	3159	1520	1777,90	2133,50

EN442 output at 20°C room temperature



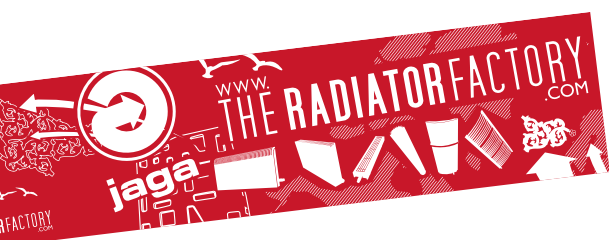

Jaga International
Verbindingslaan z/n
B-3590 Diepenbeek

Tel.: +32 (0)11 29 41 16
Fax: +32 (0)11 29 41 60
export@jaga.be

The information in this price list is correct at the time of printing.
Jaga reserves the right to change product specification at any time in line
with our policy of continuous improvement and innovation.
All prices in Euro, exclude VAT. Prices valid from 1 August 2016.
Replaces all existing price lists.